



Keep Rolling...

# PRODUCT CATALOG

Conveyor Rollers, Pulleys & Stations



## Dünden Bugüne

*From past to today*



1985



Ostim Sanayi Bölgesi 200 m<sup>2</sup>  
*Ostim Industrial Zone 200 m<sup>2</sup>*



2003



İvedik Organize Sanayi Bölgesi 2025 m<sup>2</sup>  
*İvedik Organized Industrial Zone 2025 m<sup>2</sup>*



2014



Sincan Organize Sanayi Bölgesi  
7500 m<sup>2</sup> kapalı 1500 m<sup>2</sup> açık  
*Sincan Organized Industrial Zone  
7500 m<sup>2</sup> closed 1500 m<sup>2</sup> open*



## Hakkımızda

### About Us



Kuruluş 1985  
*Establishment 1985*



7500 m<sup>2</sup> Kapalı Alan, 1500 m<sup>2</sup> Açık Alan  
*7500 m<sup>2</sup> closed area 1500 m<sup>2</sup> open area*



2.000.000 adet Üretim Kapasitesi  
*2.000.000 item production capacity*



Müşteri Odaklı Esnek Üretim  
*Flexible production with customer focus*



Sürdürülebilir Çözüm  
*Sustainable solution*

RollPlus is a brand of Pres-San, representing the modern, innovative, and technology-driven face of our conveyor roller and system solutions. Founded in 1985 by İsmail Göktürk, Pres-San has built more than four decades of experience in the bulk material handling and automation industries. Building on this strong engineering heritage, RollPlus was created to meet today's and tomorrow's industrial needs with a sharper focus on advanced manufacturing, efficiency, and performance. Production is carried out in Pres-San's facilities, consisting of 7,500 m<sup>2</sup> of indoor and 1,500 m<sup>2</sup> of outdoor manufacturing space. With the integration of fully automated roller production lines and robotic welding systems for conveyor stations in 2022, our annual production capacity has increased from 1,000,000 to 2,000,000 units, ensuring high consistency, precision, and reliability.

### Our Product Range

Under the RollPlus brand, we manufacture high-performance conveyor components, including:

- Conveyor rollers (carrying, return, impact, guide, rubber-coated, helical, conical and special rollers)
- Conveyor idler stations and frames
- Drive, tail and tension drums
- Conveyor spare parts and customized solutions for specific applications

### Our Approach

RollPlus combines Pres-San's proven experience with modern design, innovative engineering, and advanced production technologies. Our products are designed to perform reliably under demanding conditions such as heavy loads, high speeds, extreme temperatures, dust, and moisture.

With RollPlus, we move beyond manufacturing — we deliver confidence, continuity, and performance for conveyor systems used across industries worldwide.

RollPlus – Engineered by experience. Powered by innovation.

## Misyonumuz

### Our Mission

Pres-San, madencilikten çimento üretimine, geri dönüşümden intralojistiğe kadar geniş bir sektör yelpazesi için yüksek kaliteli konveyör ruloları, istasyonları ve tamburları üretmektedir. Orta Doğu, Afrika, Asya ve Avrupa'daki güçlü varlığımızla, endüstrinin ihtiyaçlarına uygun otomasyonel üretim teknikleriyle donatılmış yenilikçi taşıma çözümleri sunuyoruz. Verimliliği artıran ve operasyonel maliyetleri düşüren sistemlerimizle, küresel pazarda rekabet avantajı sağlıyoruz.

*Pres-San manufactures high-quality conveyor rollers, stations, and drums for a wide range of industries, from mining and cement production to recycling and intralogistics. With a strong presence in the Middle East, Africa, Asia, and Europe, we provide innovative conveying solutions tailored to industrial needs, leveraging automation-driven manufacturing techniques. Our systems enhance efficiency, reduce operational costs, and create a competitive advantage in the global market.*



#### Güvenilir Trustworthy

Tüm süreçlerde, müşterinin ihtiyaç ve beklentilerini tam olarak karşılayan güvenilir ve aranan bir firmayız.

*We are a reliable and sought-after company that fully meets the needs and expectations of the customer in all processes.*



#### Teknolojik Technological

Maliyetleri düşürmek ve karlılığı arttırmak için teknolojik gelişmeleri yakından takip edip, uyguluyoruz.

*Reduce costs and We closely follow and apply technological developments in order to increase profitability.*



#### Kaliteli Quality

Çalışanların, yeteneklerini en üst seviyede kullanabilmeleri için ekip çalışmasına önem vererek kalite düzeyini yükseltiyoruz.

*We increase the quality level by giving importance to teamwork so that our employees can use their talents at the highest level.*



#### Küresel Global

Küresel ölçekte rekabet gücümüzü artırarak, teknik, idari ve finansal bilgi birikimimizi yurt dışına taşıyor ve ülkemizi en iyi şekilde temsil ediyoruz. Güçlü iş birlikleri ve sürdürülebilir çözümlerle uluslararası arenada kalıcı bir iz bırakmayı hedefliyoruz.

*By enhancing our global competitiveness, we are expanding our technical, administrative, and financial expertise to international markets, proudly representing our country. Through strong partnerships and sustainable solutions, we aim to leave a lasting mark on the global stage.*



Keep Rolling...





## Vizyonumuz *Vision*

Kaliteli üretim, yenilikçi teknolojiler ve müşteri memnuniyetini esas alan hizmet anlayışımız ile dünya çapında güvenilir bir marka olmayı hedefliyoruz. Türkiye’de konveyör sistemleri sektöründe en yüksek müşteri değerine sahip şirket olarak, uluslararası pazarda sektörümüzün öncüsü olmayı amaçlıyoruz.

*With high-quality production, innovative technologies, and a service approach focused on customer satisfaction, we aim to become a globally trusted brand. As the company with the highest customer value in the conveyor systems sector in Turkey, we strive to be a pioneer in our industry in the international market.*

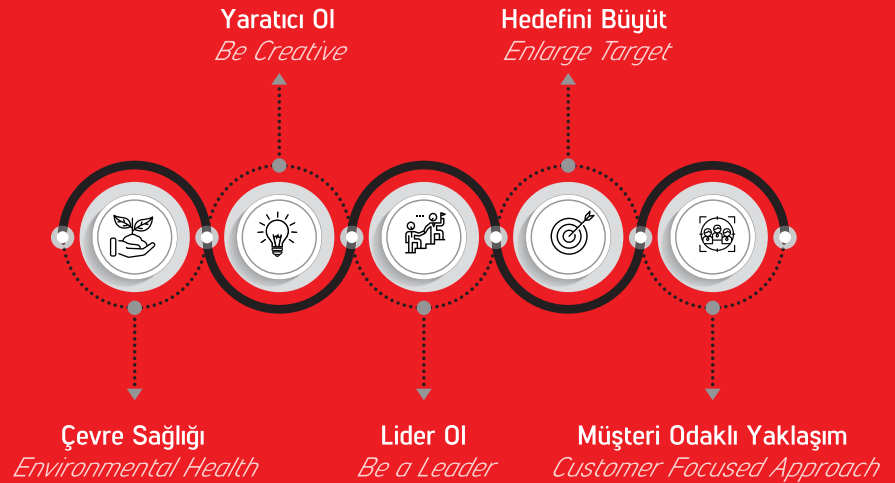

## Ürün Detayı

### Product Details

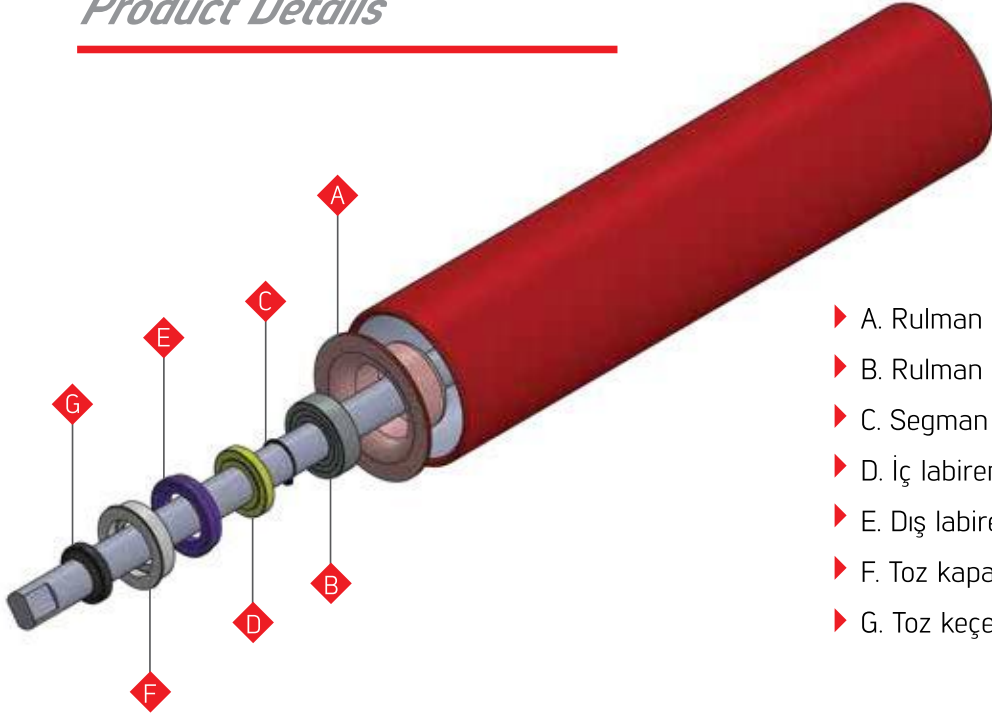

- ▶ A. Rulman yatağı
- ▶ B. Rulman
- ▶ C. Segman
- ▶ D. İç labirent
- ▶ E. Dış labirent
- ▶ F. Toz kapağı
- ▶ G. Toz keçesi

- ▶ A. Bearing housing
- ▶ B. Bearing
- ▶ C. Circlip
- ▶ D. Inner labyrinth
- ▶ E. Outer labyrinth
- ▶ F. Dust cover
- ▶ G. Dust felt

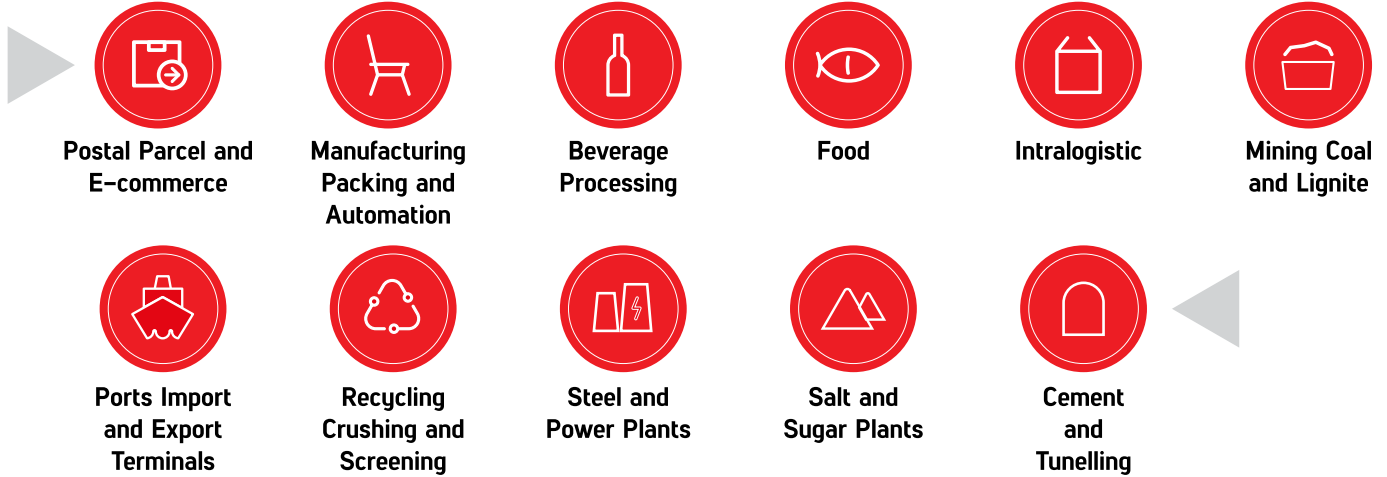

## Pres-san Ürünlerinin Başlıca Özellikleri

### *Main Features of Our Products*

- |   |   |  |
|---|---|--|
| Bakım Gerektirmeyen<br>Tasarım  |    | <i>Maintenance-Free Design<br/>Belt-Friendly</i>   |
| Rulman Yatağı Uyumu ve Mil Ucu Hassasiyeti<br>İçin Hassas İşleme                            |    | <i>Precision Machining for Bearing Fit and<br/>Shaft Accuracy</i>                                    |
| Toz ve Suyun Geçişini %100 Engelleyen<br>Sızdırmaz Labirent                                 |    | <i>100% Sealed Labyrinth to Prevent Dust and<br/>Water Ingress</i>                                   |
| Mil Ucu Anahtar Ağız ve Boru Başlarının Aynı<br>Anda İşlenmesi ile Paralellik ve Hassasiyet |   | <i>Simultaneous Machining for Shaft Flats and Tube<br/>Ends for Perfect Parallelism and Accuracy</i> |
| Banda Zarar Vermeyen<br>Çift Taraflı Radüslü Rulo   |  | <i>Belt-Friendly Roller with Double-Sided<br/>Radius Ends</i>  |
| Rulo Kapaklarında Sac Kalınlığı İnceltilmeden<br>Derin Çekme Yapılması                      |  | <i>Deep-Drawn Roller Caps Without Reducing<br/>Steel Thickness</i>                                   |
| Boru Salgı Toleransının DIN 22112<br>Standartlarına Uygunluğu                               |  | <i>Tube Runout Tolerance in Compliance with<br/>DIN 22112 Standards</i>                              |

## Taşıyıcı Rulo

### *Carrier Roller*



**Taşıyıcı Rulo:** Yüksek ve orta hızdaki yük konveyörleri için dizayn edilmiştir.

*Carrier Roller: Designed for high and medium speed conveyors.*



## Avare Rulo

### *Idler Rolls*



Konveyör sistemleri üzerinde hareket ettirilen yükün ağırlığını taşımak için tasarlanmış tahriksiz mekanizmalardır.

*Idle rolls are non-driven mechanisms designed to carry the weight of the load moved on Conveyor systems.*



## Garland

### *Garland*



Garland tipi rulolar çoğunlukla yüksek hızlı geniş bantlara sahip maden alanlarında ve yer altı konveyörlerinde kullanılmaktadır. Garland tipi rulo setlerinde rulolar peşpeşe olarak ikiden beşe kadar adetlerle birbirlerine zincir gibi esnek bir bağ ile bağlıdır.

*Garland: The type rollers are mostly used in mining areas and underground conveyors with high-speed wide belts. In garland type roll sets, two to five rolls are connected to each other with a flexible bond like a chain.*



## Kilitli Rulo

### One Way Roller



**Kilitli Rulo:** Eğimli konveyörlerde duruş esnasına tambura binen yükü hafifletmek ve bandın geri kaçmasına engel olmak için bant yönünün tersine dönmeyen, sadece bant yönünde dönen Firmamıza ait özel mekanizmalı rulolardır.

*One Way Roller:* They are rollers with special mechanism belonging to our company that rotate only in the direction of the belt in order to alleviate the load on the drum during downtime in inclined conveyors and to prevent the belt from running back.



## Darbe Rulosu

### Impact Roller



**Darbe Rulosu:** Banda düşen malzemelerin oluşturduğu basınca karşı gelen ve absorbe eden, üzerinde disklerin bulunduğu, temeli çelik rulo dizaynından oluşan şok emici rulolardır.

*Impact Roller:* This roller absorbs the pressure and shock created by falling materials. It is formed from a steel roller with discs on it.



## Helis Diskli Rulo

### Helix Disc Roller



**Helis Diskli Rulo:** Konveyör bant temizleme rulolarıdır. Rulonun ortasından kenarına doğru dönüş yaparak bandın yüzeyine yapışmış malzemeleri temizler.

*Helix Disc Roller:* The roller is a conveyor belt cleaning roller. It cleans the materials adhering to the surface of the band by rotating from the center of the roll to the edge.





## Kauçuk Kaplamalı (Vulkanize) Rulo

### *Rubber Coated (Vulcanized) Roller*



**Kauçuk Kaplamalı (Vulkanize) Rulo:** Büyük parça malzeme taşıyan ağır yüklü bandlı konveyörlerde banda düşen malzemelerin oluşturduğu basınca karşı gelen ve absorbe eden, üzerinde disklerin bulunduğu, temeli çelik rulo dizaynından oluşan şok emici rulolardır.

***Rubber Coated (Vulcanized) Roller:** This roller absorbs the pressure and shock created by falling materials in large material conveyor systems with heavy-duty conveyor belts. It is formed from a steel roller with hot vulcanized coating on roller.*



## Dönüş Rulosu

### *Return Roller*



**Dönüş Ruloları:** Dönüş hattı boyunca bandın akışını sağlamak ve desteklemek için kullanılırlar. Taşınan malzemenin banda yapışmaya meyilli veya aşınma problem olması durumunda lastik diskli olarak imal edilebilirler.

***Return Roller:** This roller is used to provide and support the flow of the belt along the return line. If the material to be transported has a tendency to stick or if there are abrasion problems, the roller can be manufactured with rubber discs.*



## Kılavuz Rulosu

### *Guide Roller*



**Kılavuz Ruloları:** Bandın kaymasını engelleyen ve merkezleyen konsol destekli milli dikey rulolar.

***Guide Roller:** Cantilever-supported vertical rollers that prevent and center the belt's slip.*



## Zincir Dişli Rulo

### Chain Gear Roller



**Zincir Dişli Rulo:** Dişliler sayesinde motordan aldığı hareketin diğer rulolara aktaran rulo çeşididir.

*Chain Gear Roller:* This kind of roller transfers movement from the motor to the other rollers via gears.



## Konik Rulo

### Conical Roller



**Konik Rulo:** Genel olarak ağır yükler için tercih edilir ve konveyör hattına dönüş vermek için kullanılır.

*Conical Roller:* Generally, this roller is preferred for heavy loads and is used to allow the conveyor line to return.



## Gergi Tamburu

### Tension Pulley



**Gergi Tamburu:** Ağırlıklı gergi tamburları konveyör bandı için ihtiyaç duyulan gergi miktarının konveyör bandının her yerinde eşit olarak etkin olmasını sağlar.

*Tension Pulley:* Ensures that the amount of tension is equally effective throughout the conveyor belt.



## Tahrik Tamburu

### Drive Pulley



**Tahrik Tamburu:** Konveyörlerde bant kayışına hareket verir ve bandın başına takılır.

*Drive Pulley:* Gives movement to the belt strap and is placed at its head.



## Endüstriyel Rulolar

### Industrial Roller



"Move on with experience. carry with confidence."



**OTOMATİK PAKETLEME SİSTEMİ**  
*AUTOMATED PACKING SYSTEM*



**KOLİN TERMİK SANTRAL**  
*KOLIN THERMAL POWER PLANT*



## Taşıyıcı Rulo İstasyonu

### *Carrying Roller Stations*



Taşıyıcı rulo istasyonları / Darbe rulosu istasyonları, konveyör bant sistemlerinde malzeme taşımayı destekleyen kritik bileşenlerdir. Bu istasyonlar, ruloların uygun konumda tutulmasını sağlayarak bant hareketini dengeler ve sistemin verimli çalışmasına katkıda bulunur. Farklı taşıma gereksinimlerine uyum sağlamak için çeşitli tasarım ve konfigürasyonlarda üretilmektedir.

## Darbe Rulosu İstasyonu

### *Impact Roller Stations*



*Conveyor roller stations / Impact roller stations are critical components in conveyor belt systems, supporting material transportation. These stations ensure proper roller alignment, balance belt movement, and contribute to the system's overall efficiency. They are manufactured in various designs and configurations to meet different conveying needs.*

## Kızaklı İstasyon

### *Sliding Station*



**Kızaklı İstasyon:** Montaj ve bakımın zor olduğu bölgelerde kullanılmak üzere, sabit bir gövde üzerinde ruloların bulunduğu kızaklı yapı, bakımı ve montajı kolaylaştırmaktadır. Bant üzerinde yük bulunması durumunda, ek olarak kriko sistemleriyle bandın yükünü alıp kızaklama hareketini daha da kolaylaştırabilmekteyiz. Kızaklı istasyonlar her konveyör için özel ölçülerde imal edilebilir.

***Sliding Station:*** To be used in areas where assembly and maintenance is difficult, the sliding structure with rollers on a fixed body facilitates maintenance and assembly. If there is a load on the belt, we can additionally take the load of the belt and facilitate the aquaplaning movement with the jack systems. Skid stations can be manufactured in special sizes for each conveyor.

## Darbe Bari

### Impact Bar



Darbe bari malzeme yükleme noktalarında bant ve şasenin zarar görmesini, döküntünün dağılmasını engellemek ve düşen malzemeye karşı darbe dayanımı sağlamak için kullanılır.

*Impact bars are used at material loading points to prevent damage to the belt and chassis, to prevent the scattering of material, and to provide impact resistance against falling materials.*



## Bant Sıyırıcıları

### Belt Cleaners



Primer, seconder, V tip ve Y tip sıyırıcı tedariği mevcuttur.

*Primary, secondary, V type and Y type scrapers are available.*



## Bant Lastiği

### Conveyor Belt



Konveyör kullanılan tüm sektörler için her çeşit bant lastiği tedariği mevcuttur.

*All types of conveyor belt are available for all sectors where conveyors are used.*





## Geri Dönüş Rulosu Tutucuları ve İstasyonları

### *Return Roller Stations and Brackets*



## Alt ve Üst Ayar Rulosu İstasyonları

### *Lower and Upper Self Centralising Roller Stations*



**Kendinden Hizalamalı Rulo İstasyonları:** Kendinden hizalamalı rulo istasyonları, konveyör sistemlerinde kullanılan ve konveyör bantlarını destekleyip yönlendiren bileşenlerdir. Bu istasyonlar, bantın çalışma sırasında doğru hizalanmasını sağlamak için tasarlanmıştır. Bu sayede aşınma ve yıpranma azalır ve konveyör sisteminin genel verimliliği artar.

*Self Aligning Idlers Stations: Self-aligning idler transoms are components used in conveyor systems to support and guide conveyor belts. These transoms are designed to maintain proper alignment of the belt during operation, which helps reduce wear and tear and improves the overall efficiency of the conveyor system.*



**ALTIN MADENİ TÜRKİYE**  
*GOLD MINE TURKIYE*



**GERİ DÖNÜŞÜM TESİSİ**  
*RECYCLING FACILITY*



**CAM FABRİKASI**  
*GLASS INDUSTRY*



**PAKETLEME HATTI**  
*PACKING LINE*

## Rulo ve İstasyon Ekipmanları

### *Roller and Station Equipments*

- ▶ A. Rulman Yatakları
- ▶ B. Rulo Askı Ayakları
- ▶ C. Darbe ve Dönüş Diskleri
- ▶ D. Polyamid Rulman Yatakları ve Keçeler
- ▶ E. Özel Pres Baskı, Derin Çekme ve Kalıp İşleri

- ▶ *A. Bearing Housings*
- ▶ *B. Roll Hanger Feet*
- ▶ *C. Impact and Return Discs*
- ▶ *D. Polyamide Bearing Housings and Seals*
- ▶ *E. Deep Drawing, Special Press Printing and Mold Works*

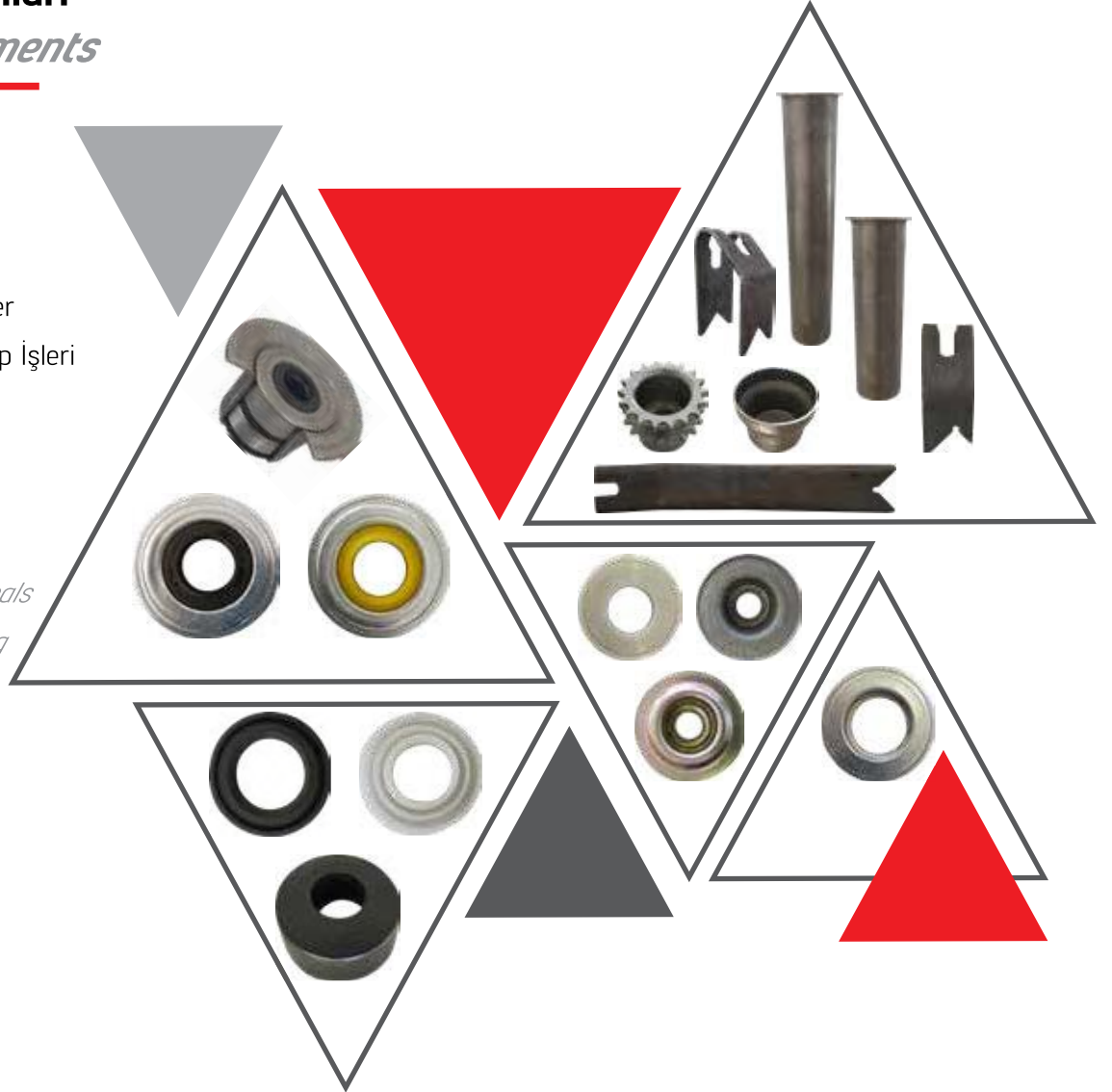



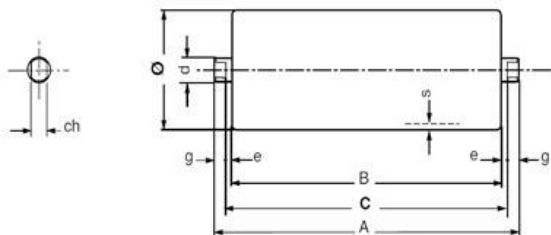

Code: **RollPlus**

RPS/1-ROL,20F,63N,608

Type	Serie	Roller Dia.	Bearing	Shaft Dia.	B	C	A
Carrier	RPS/1-ROL	63	6204	20	160	168	186
Carrier	RPS/1-ROL	63	6204	20	200	208	226
Carrier	RPS/1-ROL	63	6204	20	250	258	276
Carrier	RPS/1-ROL	63	6204	20	315	323	341
Carrier	RPS/1-ROL	63	6204	20	380	388	406
Carrier	RPS/1-ROL	63	6204	20	465	473	491
Carrier	RPS/1-ROL	63	6204	20	500	508	526
Carrier	RPS/1-ROL	63	6204	20	600	608	626
Carrier	RPS/1-ROL	63	6204	20	700	708	726
Carrier	RPS/1-ROL	63	6204	20	750	758	776
Carrier	RPS/1-ROL	63	6204	20	950	958	976
Carrier	RPS/1-ROL	63	6204	20	1150	1158	1176
Carrier	RPS/1-ROL	63	6204	20	1400	1408	1426
Carrier	RPS/1-ROL	89	6204	20	160	168	186
Carrier	RPS/1-ROL	89	6204	20	200	208	226
Carrier	RPS/1-ROL	89	6204	20	250	258	276
Carrier	RPS/1-ROL	89	6204	20	315	323	341
Carrier	RPS/1-ROL	89	6204	20	380	388	406
Carrier	RPS/1-ROL	89	6204	20	465	473	491
Carrier	RPS/1-ROL	89	6204	20	500	508	526
Carrier	RPS/1-ROL	89	6204	20	530	538	556
Carrier	RPS/1-ROL	89	6204	20	600	608	626
Carrier	RPS/1-ROL	89	6204	20	700	708	726
Carrier	RPS/1-ROL	89	6204	20	750	758	776
Carrier	RPS/1-ROL	89	6204	20	800	808	826
Carrier	RPS/1-ROL	89	6204	20	950	958	976
Carrier	RPS/1-ROL	89	6204	20	1150	1158	1176
Carrier	RPS/1-ROL	89	6204	20	1400	1408	1426
Carrier	RPS/1-ROL	89	6204	20	1600	1608	1626

Type	Serie	Roller Dia.	Bearing	Shaft Dia.	B	C	A
Carrier	RPS/1-ROL	108	6204	20	160	168	186
Carrier	RPS/1-ROL	108	6204	20	200	208	226
Carrier	RPS/1-ROL	108	6204	20	250	258	276
Carrier	RPS/1-ROL	108	6204	20	315	323	341
Carrier	RPS/1-ROL	108	6204	20	380	388	406
Carrier	RPS/1-ROL	108	6204	20	465	473	491
Carrier	RPS/1-ROL	108	6204	20	500	508	526
Carrier	RPS/1-ROL	108	6204	20	530	538	556
Carrier	RPS/1-ROL	108	6204	20	600	608	626
Carrier	RPS/1-ROL	108	6204	20	700	708	726
Carrier	RPS/1-ROL	108	6204	20	750	758	776
Carrier	RPS/1-ROL	108	6204	20	800	808	826
Carrier	RPS/1-ROL	108	6204	20	950	958	976
Carrier	RPS/1-ROL	108	6204	20	1150	1158	1176
Carrier	RPS/1-ROL	108	6204	20	1400	1408	1426
Carrier	RPS/1-ROL	108	6204	20	1600	1608	1626
Carrier	RPS/1-ROL	133	6204	20	200	208	226
Carrier	RPS/1-ROL	133	6204	20	250	258	276
Carrier	RPS/1-ROL	133	6204	20	315	323	341
Carrier	RPS/1-ROL	133	6204	20	380	388	406
Carrier	RPS/1-ROL	133	6204	20	465	473	491
Carrier	RPS/1-ROL	133	6204	20	530	538	556
Carrier	RPS/1-ROL	133	6204	20	600	608	626
Carrier	RPS/1-ROL	133	6204	20	700	708	726
Carrier	RPS/1-ROL	133	6204	20	750	758	776
Carrier	RPS/1-ROL	133	6204	20	800	808	826
Carrier	RPS/1-ROL	133	6204	20	900	908	926
Carrier	RPS/1-ROL	133	6204	20	950	958	976
Carrier	RPS/1-ROL	133	6204	20	1150	1158	1176
Carrier	RPS/1-ROL	133	6204	20	1400	1408	1426
Carrier	RPS/1-ROL	133	6204	20	1600	1608	1626
Carrier	RPS/1-ROL	133	6204	20	1800	1808	1826



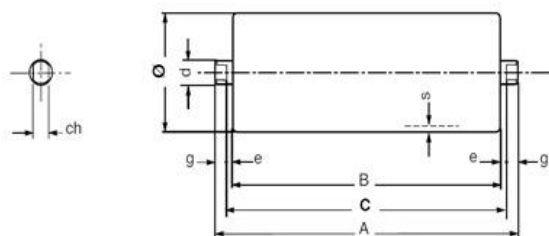

Code: **RollPlus**

RPS/1-ROL,20F,63N,608

Type	Serie	Roller Dia.	Bearing	Shaft Dia.	B	C	A
Carrier	RPS/3-ROL	89	6305	25	250	258	282
Carrier	RPS/3-ROL	89	6305	25	315	323	347
Carrier	RPS/3-ROL	89	6305	25	380	388	412
Carrier	RPS/3-ROL	89	6305	25	465	473	497
Carrier	RPS/3-ROL	89	6305	25	530	538	562
Carrier	RPS/3-ROL	89	6305	25	600	608	632
Carrier	RPS/3-ROL	89	6305	25	700	708	732
Carrier	RPS/3-ROL	89	6305	25	750	758	782
Carrier	RPS/3-ROL	89	6305	25	800	808	832
Carrier	RPS/3-ROL	89	6305	25	900	908	932
Carrier	RPS/3-ROL	89	6305	25	950	958	982
Carrier	RPS/3-ROL	89	6305	25	1150	1158	1182
Carrier	RPS/3-ROL	89	6305	25	1400	1408	1432
Carrier	RPS/3-ROL	89	6305	25	1600	1608	1632
Carrier	RPS/3-ROL	89	6305	25	1800	1808	1832
Carrier	RPS/3-ROL	108	6305	25	250	258	282
Carrier	RPS/3-ROL	108	6305	25	315	323	347
Carrier	RPS/3-ROL	108	6305	25	380	388	412
Carrier	RPS/3-ROL	108	6305	25	465	473	497
Carrier	RPS/3-ROL	108	6305	25	530	538	562
Carrier	RPS/3-ROL	108	6305	25	600	608	632
Carrier	RPS/3-ROL	108	6305	25	700	708	732
Carrier	RPS/3-ROL	108	6305	25	750	758	782
Carrier	RPS/3-ROL	108	6305	25	800	808	832
Carrier	RPS/3-ROL	108	6305	25	900	908	932
Carrier	RPS/3-ROL	108	6305	25	950	958	982
Carrier	RPS/3-ROL	108	6305	25	1150	1158	1182
Carrier	RPS/3-ROL	108	6305	25	1400	1408	1432
Carrier	RPS/3-ROL	108	6305	25	1600	1608	1632
Carrier	RPS/3-ROL	108	6305	25	1800	1808	1832

Type	Serie	Roller Dia.	Bearing	Shaft Dia.	B	C	A
Carrier	RPS/3-ROL	133	6305	25	315	323	347
Carrier	RPS/3-ROL	133	6305	25	380	388	412
Carrier	RPS/3-ROL	133	6305	25	465	473	497
Carrier	RPS/3-ROL	133	6305	25	530	538	562
Carrier	RPS/3-ROL	133	6305	25	600	608	632
Carrier	RPS/3-ROL	133	6305	25	670	678	702
Carrier	RPS/3-ROL	133	6305	25	700	708	732
Carrier	RPS/3-ROL	133	6305	25	750	758	782
Carrier	RPS/3-ROL	133	6305	25	800	808	832
Carrier	RPS/3-ROL	133	6305	25	900	908	932
Carrier	RPS/3-ROL	133	6305	25	1000	1008	1032
Carrier	RPS/3-ROL	133	6305	25	1100	1108	1132
Carrier	RPS/3-ROL	133	6305	25	1150	1158	1182
Carrier	RPS/3-ROL	133	6305	25	1400	1408	1432
Carrier	RPS/3-ROL	133	6305	25	1600	1608	1632
Carrier	RPS/3-ROL	133	6305	25	1800	1808	1832
Carrier	RPS/3-ROL	133	6305	25	2000	2008	2032
Carrier	RPS/3-ROL	133	6305	25	2200	2208	2232
Carrier	RPS/3-ROL	159	6305	25	380	388	412
Carrier	RPS/3-ROL	159	6305	25	465	473	497
Carrier	RPS/3-ROL	159	6305	25	530	538	562
Carrier	RPS/3-ROL	159	6305	25	600	608	632
Carrier	RPS/3-ROL	159	6305	25	670	678	702
Carrier	RPS/3-ROL	159	6305	25	700	708	732
Carrier	RPS/3-ROL	159	6305	25	750	758	782
Carrier	RPS/3-ROL	159	6305	25	800	808	832
Carrier	RPS/3-ROL	159	6305	25	900	908	932
Carrier	RPS/3-ROL	159	6305	25	1000	1008	1032
Carrier	RPS/3-ROL	159	6305	25	1100	1108	1132
Carrier	RPS/3-ROL	159	6305	25	1150	1158	1182
Carrier	RPS/3-ROL	159	6305	25	1400	1408	1432
Carrier	RPS/3-ROL	159	6305	25	1600	1608	1632
Carrier	RPS/3-ROL	159	6305	25	1800	1808	1832
Carrier	RPS/3-ROL	159	6305	25	2000	2008	2032
Carrier	RPS/3-ROL	159	6305	25	2200	2208	2232



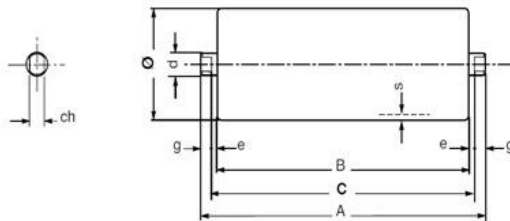

Code: **RollPlus**

RPS/1-ROL,20F,63N,608

Type	Serie	Roller Dia.	Bearing	Shaft Dia.	B	C	A
Carrier	RPS/4-ROL	89	6206	30	315	323	347
Carrier	RPS/4-ROL	89	6206	30	380	388	412
Carrier	RPS/4-ROL	89	6206	30	465	473	497
Carrier	RPS/4-ROL	89	6206	30	530	538	562
Carrier	RPS/4-ROL	89	6206	30	600	608	632
Carrier	RPS/4-ROL	89	6206	30	700	708	732
Carrier	RPS/4-ROL	89	6206	30	800	808	832
Carrier	RPS/4-ROL	89	6206	30	900	908	932
Carrier	RPS/4-ROL	89	6206	30	950	958	982
Carrier	RPS/4-ROL	89	6206	30	1150	1158	1182
Carrier	RPS/4-ROL	89	6206	30	1400	1408	1432
Carrier	RPS/4-ROL	89	6206	30	1600	1608	1632
Carrier	RPS/4-ROL	89	6206	30	1800	1808	1832
Carrier	RPS/4-ROL	108	6206	30	315	323	347
Carrier	RPS/4-ROL	108	6206	30	380	388	412
Carrier	RPS/4-ROL	108	6206	30	465	473	497
Carrier	RPS/4-ROL	108	6206	30	530	538	562
Carrier	RPS/4-ROL	108	6206	30	600	608	632
Carrier	RPS/4-ROL	108	6206	30	700	708	732
Carrier	RPS/4-ROL	108	6206	30	800	808	832
Carrier	RPS/4-ROL	108	6206	30	900	908	932
Carrier	RPS/4-ROL	108	6206	30	950	958	982
Carrier	RPS/4-ROL	108	6206	30	1150	1158	1182
Carrier	RPS/4-ROL	108	6206	30	1400	1408	1432
Carrier	RPS/4-ROL	108	6206	30	1600	1608	1632
Carrier	RPS/4-ROL	108	6206	30	1800	1808	1832

Type	Serie	Roller Dia.	Bearing	Shaft Dia.	B	C	A
Carrier	RPS/4-ROL	133	6206	30	315	323	347
Carrier	RPS/4-ROL	133	6206	30	380	388	412
Carrier	RPS/4-ROL	133	6206	30	465	473	497
Carrier	RPS/4-ROL	133	6206	30	530	538	562
Carrier	RPS/4-ROL	133	6206	30	600	608	632
Carrier	RPS/4-ROL	133	6206	30	670	678	702
Carrier	RPS/4-ROL	133	6206	30	700	708	732
Carrier	RPS/4-ROL	133	6206	30	750	758	782
Carrier	RPS/4-ROL	133	6206	30	800	808	832
Carrier	RPS/4-ROL	133	6206	30	900	908	932
Carrier	RPS/4-ROL	133	6206	30	950	958	982
Carrier	RPS/4-ROL	133	6206	30	1000	1008	1032
Carrier	RPS/4-ROL	133	6206	30	1100	1108	1132
Carrier	RPS/4-ROL	133	6206	30	1150	1158	1182
Carrier	RPS/4-ROL	133	6206	30	1400	1408	1432
Carrier	RPS/4-ROL	133	6206	30	1600	1608	1632
Carrier	RPS/4-ROL	133	6206	30	1800	1808	1832
Carrier	RPS/4-ROL	133	6206	30	2000	2008	2032
Carrier	RPS/4-ROL	133	6206	30	2200	2208	2232
Carrier	RPS/4-ROL	159	6206	30	315	323	347
Carrier	RPS/4-ROL	159	6206	30	380	388	412
Carrier	RPS/4-ROL	159	6206	30	465	473	497
Carrier	RPS/4-ROL	159	6206	30	530	538	562
Carrier	RPS/4-ROL	159	6206	30	600	608	632
Carrier	RPS/4-ROL	159	6206	30	670	678	702
Carrier	RPS/4-ROL	159	6206	30	700	708	732
Carrier	RPS/4-ROL	159	6206	30	750	758	782
Carrier	RPS/4-ROL	159	6206	30	800	808	832
Carrier	RPS/4-ROL	159	6206	30	900	908	932
Carrier	RPS/4-ROL	159	6206	30	950	958	982
Carrier	RPS/4-ROL	159	6206	30	1000	1008	1032
Carrier	RPS/4-ROL	159	6206	30	1100	1108	1132
Carrier	RPS/4-ROL	159	6206	30	1150	1158	1182
Carrier	RPS/4-ROL	159	6206	30	1400	1408	1432
Carrier	RPS/4-ROL	159	6206	30	1600	1608	1632
Carrier	RPS/4-ROL	159	6206	30	1800	1808	1832
Carrier	RPS/4-ROL	159	6206	30	2000	2008	2032
Carrier	RPS/4-ROL	159	6206	30	2200	2208	2232





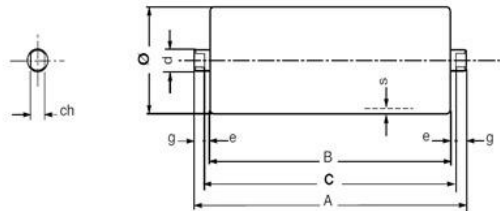

Code: **RollPlus**

RPS/1-ROL,20F,63N,608

Type	Serie	Roller Dia.	Bearing	Shaft Dia.	B	C	A	Type	Serie	Roller Dia.	Bearing	Shaft Dia.	B	C	A
Carrier	RPS/5-ROL	89	6306	30	315	323	347	Carrier	RPS/5-ROL	133	6306	30	315	323	347
Carrier	RPS/5-ROL	89	6306	30	380	388	412	Carrier	RPS/5-ROL	133	6306	30	380	388	412
Carrier	RPS/5-ROL	89	6306	30	465	473	497	Carrier	RPS/5-ROL	133	6306	30	465	473	497
Carrier	RPS/5-ROL	89	6306	30	530	538	562	Carrier	RPS/5-ROL	133	6306	30	530	538	562
Carrier	RPS/5-ROL	89	6306	30	600	608	632	Carrier	RPS/5-ROL	133	6306	30	600	608	632
Carrier	RPS/5-ROL	89	6306	30	670	678	702	Carrier	RPS/5-ROL	133	6306	30	670	678	702
Carrier	RPS/5-ROL	89	6306	30	700	708	732	Carrier	RPS/5-ROL	133	6306	30	700	708	732
Carrier	RPS/5-ROL	89	6306	30	750	758	782	Carrier	RPS/5-ROL	133	6306	30	750	758	782
Carrier	RPS/5-ROL	89	6306	30	800	808	832	Carrier	RPS/5-ROL	133	6306	30	800	808	832
Carrier	RPS/5-ROL	89	6306	30	900	908	932	Carrier	RPS/5-ROL	133	6306	30	900	908	932
Carrier	RPS/5-ROL	89	6306	30	950	958	982	Carrier	RPS/5-ROL	133	6306	30	950	958	982
Carrier	RPS/5-ROL	89	6306	30	1000	1008	1032	Carrier	RPS/5-ROL	133	6306	30	1000	1008	1032
Carrier	RPS/5-ROL	89	6306	30	1100	1108	1132	Carrier	RPS/5-ROL	133	6306	30	1100	1108	1132
Carrier	RPS/5-ROL	89	6306	30	1150	1158	1182	Carrier	RPS/5-ROL	133	6306	30	1150	1158	1182
Carrier	RPS/5-ROL	89	6306	30	1400	1408	1432	Carrier	RPS/5-ROL	133	6306	30	1400	1408	1432
Carrier	RPS/5-ROL	89	6306	30	1600	1608	1632	Carrier	RPS/5-ROL	133	6306	30	1600	1608	1632
Carrier	RPS/5-ROL	89	6306	30	1800	1808	1832	Carrier	RPS/5-ROL	133	6306	30	1800	1808	1832
Carrier	RPS/5-ROL	89	6306	30	2000	2008	2032	Carrier	RPS/5-ROL	133	6306	30	2000	2008	2032
Carrier	RPS/5-ROL	89	6306	30	2200	2208	2232	Carrier	RPS/5-ROL	133	6306	30	2200	2208	2232
Carrier	RPS/5-ROL	108	6306	30	315	323	347	Carrier	RPS/5-ROL	159	6306	30	315	323	347
Carrier	RPS/5-ROL	108	6306	30	380	388	412	Carrier	RPS/5-ROL	159	6306	30	380	388	412
Carrier	RPS/5-ROL	108	6306	30	465	473	497	Carrier	RPS/5-ROL	159	6306	30	465	473	497
Carrier	RPS/5-ROL	108	6306	30	530	538	562	Carrier	RPS/5-ROL	159	6306	30	530	538	562
Carrier	RPS/5-ROL	108	6306	30	600	608	632	Carrier	RPS/5-ROL	159	6306	30	600	608	632
Carrier	RPS/5-ROL	108	6306	30	670	678	702	Carrier	RPS/5-ROL	159	6306	30	670	678	702
Carrier	RPS/5-ROL	108	6306	30	700	708	732	Carrier	RPS/5-ROL	159	6306	30	700	708	732
Carrier	RPS/5-ROL	108	6306	30	750	758	782	Carrier	RPS/5-ROL	159	6306	30	750	758	782
Carrier	RPS/5-ROL	108	6306	30	800	808	832	Carrier	RPS/5-ROL	159	6306	30	800	808	832
Carrier	RPS/5-ROL	108	6306	30	900	908	932	Carrier	RPS/5-ROL	159	6306	30	900	908	932
Carrier	RPS/5-ROL	108	6306	30	950	958	982	Carrier	RPS/5-ROL	159	6306	30	950	958	982
Carrier	RPS/5-ROL	108	6306	30	1000	1008	1032	Carrier	RPS/5-ROL	159	6306	30	1000	1008	1032
Carrier	RPS/5-ROL	108	6306	30	1100	1108	1132	Carrier	RPS/5-ROL	159	6306	30	1100	1108	1132
Carrier	RPS/5-ROL	108	6306	30	1150	1158	1182	Carrier	RPS/5-ROL	159	6306	30	1150	1158	1182
Carrier	RPS/5-ROL	108	6306	30	1400	1408	1432	Carrier	RPS/5-ROL	159	6306	30	1250	1258	1282
Carrier	RPS/5-ROL	108	6306	30	1600	1608	1632	Carrier	RPS/5-ROL	159	6306	30	1400	1408	1432
Carrier	RPS/5-ROL	108	6306	30	1800	1808	1832	Carrier	RPS/5-ROL	159	6306	30	1600	1608	1632
Carrier	RPS/5-ROL	108	6306	30	2000	2008	2032	Carrier	RPS/5-ROL	159	6306	30	1800	1808	1832
Carrier	RPS/5-ROL	108	6306	30	2200	2208	2232	Carrier	RPS/5-ROL	159	6306	30	2000	2008	2032
								Carrier	RPS/5-ROL	159	6306	30	2200	2208	2232
								Carrier	RPS/5-ROL	159	6306	30	2500	2508	2532



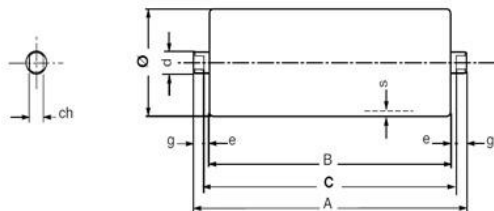

Code: **RollPlus**

RPS/1-ROL,20F,63N,608

Type	Serie	Roller Dia.	Bearing	Shaft Dia.	B	C	A	Type	Serie	Roller Dia.	Bearing	Shaft Dia.	B	C	A
Carrier	RPS/7-ROL	108	6308	40	380	388	412	Carrier	RPS/7-ROL	159	6308	40	380	388	412
Carrier	RPS/7-ROL	108	6308	40	465	473	497	Carrier	RPS/7-ROL	159	6308	40	465	473	497
Carrier	RPS/7-ROL	108	6308	40	530	538	562	Carrier	RPS/7-ROL	159	6308	40	530	538	562
Carrier	RPS/7-ROL	108	6308	40	600	608	632	Carrier	RPS/7-ROL	159	6308	40	600	608	632
Carrier	RPS/7-ROL	108	6308	40	670	678	702	Carrier	RPS/7-ROL	159	6308	40	670	678	702
Carrier	RPS/7-ROL	108	6308	40	700	708	732	Carrier	RPS/7-ROL	159	6308	40	700	708	732
Carrier	RPS/7-ROL	108	6308	40	750	758	782	Carrier	RPS/7-ROL	159	6308	40	750	758	782
Carrier	RPS/7-ROL	108	6308	40	800	808	832	Carrier	RPS/7-ROL	159	6308	40	800	808	832
Carrier	RPS/7-ROL	108	6308	40	900	908	932	Carrier	RPS/7-ROL	159	6308	40	900	908	932
Carrier	RPS/7-ROL	108	6308	40	1000	1008	1032	Carrier	RPS/7-ROL	159	6308	40	1000	1008	1032
Carrier	RPS/7-ROL	108	6308	40	1100	1108	1132	Carrier	RPS/7-ROL	159	6308	40	1100	1108	1132
Carrier	RPS/7-ROL	108	6308	40	1150	1158	1182	Carrier	RPS/7-ROL	159	6308	40	1150	1158	1182
Carrier	RPS/7-ROL	108	6308	40	1250	1258	1282	Carrier	RPS/7-ROL	159	6308	40	1250	1258	1282
Carrier	RPS/7-ROL	108	6308	40	1400	1408	1432	Carrier	RPS/7-ROL	159	6308	40	1400	1408	1432
Carrier	RPS/7-ROL	108	6308	40	1600	1608	1632	Carrier	RPS/7-ROL	159	6308	40	1600	1608	1632
Carrier	RPS/7-ROL	108	6308	40	1800	1808	1832	Carrier	RPS/7-ROL	159	6308	40	1800	1808	1832
Carrier	RPS/7-ROL	108	6308	40	2000	2008	2032	Carrier	RPS/7-ROL	159	6308	40	2000	2008	2032
Carrier	RPS/7-ROL	108	6308	40	2200	2208	2232	Carrier	RPS/7-ROL	159	6308	40	2200	2208	2232
Carrier	RPS/7-ROL	108	6308	40	2500	2508	2532	Carrier	RPS/7-ROL	159	6308	40	2500	2508	2532
Carrier	RPS/7-ROL	133	6308	40	380	388	412	Carrier	RPS/7-ROL	194	6308	40	600	608	632
Carrier	RPS/7-ROL	133	6308	40	465	473	497	Carrier	RPS/7-ROL	194	6308	40	670	678	702
Carrier	RPS/7-ROL	133	6308	40	530	538	562	Carrier	RPS/7-ROL	194	6308	40	750	758	782
Carrier	RPS/7-ROL	133	6308	40	600	608	632	Carrier	RPS/7-ROL	194	6308	40	800	808	832
Carrier	RPS/7-ROL	133	6308	40	670	678	702	Carrier	RPS/7-ROL	194	6308	40	900	908	932
Carrier	RPS/7-ROL	133	6308	40	700	708	732	Carrier	RPS/7-ROL	194	6308	40	950	958	982
Carrier	RPS/7-ROL	133	6308	40	750	758	782	Carrier	RPS/7-ROL	194	6308	40	1000	1008	1032
Carrier	RPS/7-ROL	133	6308	40	800	808	832	Carrier	RPS/7-ROL	194	6308	40	1050	1058	1082
Carrier	RPS/7-ROL	133	6308	40	900	908	932	Carrier	RPS/7-ROL	194	6308	40	1100	1108	1132
Carrier	RPS/7-ROL	133	6308	40	1000	1008	1032	Carrier	RPS/7-ROL	194	6308	40	1120	1128	1152
Carrier	RPS/7-ROL	133	6308	40	1100	1108	1132	Carrier	RPS/7-ROL	194	6308	40	1250	1258	1282
Carrier	RPS/7-ROL	133	6308	40	1150	1158	1182	Carrier	RPS/7-ROL	194	6308	40	1400	1408	1432
Carrier	RPS/7-ROL	133	6308	40	1250	1258	1282	Carrier	RPS/7-ROL	194	6308	40	1600	1608	1632
Carrier	RPS/7-ROL	133	6308	40	1400	1408	1432	Carrier	RPS/7-ROL	194	6308	40	1700	1708	1732
Carrier	RPS/7-ROL	133	6308	40	1600	1608	1632	Carrier	RPS/7-ROL	194	6308	40	1800	1808	1832
Carrier	RPS/7-ROL	133	6308	40	1800	1808	1832	Carrier	RPS/7-ROL	194	6308	40	2000	2008	2032
Carrier	RPS/7-ROL	133	6308	40	2000	2008	2032	Carrier	RPS/7-ROL	194	6308	40	2200	2208	2232
Carrier	RPS/7-ROL	133	6308	40	2200	2208	2232	Carrier	RPS/7-ROL	194	6308	40	2500	2508	2532
Carrier	RPS/7-ROL	133	6308	40	2500	2508	2532	Carrier	RPS/7-ROL	194	6308	40	2800	2808	2832
Carrier	RPS/7-ROL	133	6308	40	2500	2508	2532	Carrier	RPS/7-ROL	194	6308	40	3000	3008	3032

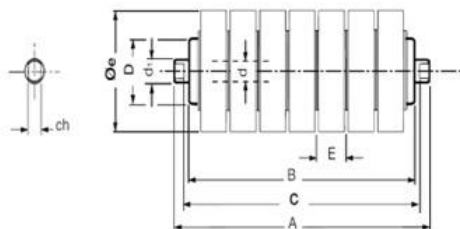

Code: **RollPlus**

RPS/1-IMP,20F,89NA,323

Type	Serie	Pipe Dia	Ring Dia	B	C	A	Type	Serie	Pipe Dia	Ring Dia	B	C	A
Impact	RPS/1-IMP	60	89	160	168	186	Impact	RPS/2-IMP	89	133	250	258	282
Impact	RPS/1-IMP	60	89	200	208	226	Impact	RPS/2-IMP	89	133	315	323	347
Impact	RPS/1-IMP	60	89	250	258	276	Impact	RPS/2-IMP	89	133	380	388	412
Impact	RPS/1-IMP	60	89	315	323	341	Impact	RPS/2-IMP	89	133	465	473	497
Impact	RPS/1-IMP	60	89	380	388	406	Impact	RPS/2-IMP	89	133	530	538	562
Impact	RPS/1-IMP	60	89	465	473	491	Impact	RPS/2-IMP	89	133	600	608	632
Impact	RPS/1-IMP	60	89	500	508	526	Impact	RPS/2-IMP	89	133	670	678	702
Impact	RPS/1-IMP	60	89	530	538	556	Impact	RPS/2-IMP	89	133	700	708	732
Impact	RPS/1-IMP	60	89	600	608	626	Impact	RPS/2-IMP	89	133	750	758	782
Impact	RPS/1-IMP	60	89	700	708	726	Impact	RPS/2-IMP	89	133	800	808	832
Impact	RPS/1-IMP	60	89	750	758	776	Impact	RPS/2-IMP	89	133	900	908	932
Impact	RPS/1-IMP	60	89	800	808	826	Impact	RPS/2-IMP	89	133	950	958	982
Impact	RPS/1-IMP	60	89	950	958	976	Impact	RPS/2-IMP	89	133	1000	1008	1032
Impact	RPS/1-IMP	60	89	1150	1158	1176	Impact	RPS/2-IMP	89	133	1150	1158	1182
Impact	RPS/1-IMP	60	89	1400	1408	1426	Impact	RPS/2-IMP	89	133	1400	1408	1432
Impact	RPS/1-IMP	60	89	1600	1608	1626	Impact	RPS/2-IMP	89	133	1600	1608	1632
Impact	RPS/1-IMP	63	108	160	168	186	Impact	RPS/2-IMP	89	133	1800	1808	1832
Impact	RPS/1-IMP	63	108	200	208	226	Impact	RPS/2-IMP	89	133	2000	2008	2032
Impact	RPS/1-IMP	63	108	250	258	276	Impact	RPS/2-IMP	89	133	2200	2208	2232
Impact	RPS/1-IMP	63	108	315	323	341	Impact	RPS/4-IMP	89	159	315	323	347
Impact	RPS/1-IMP	63	108	380	388	406	Impact	RPS/4-IMP	89	159	380	388	412
Impact	RPS/1-IMP	63	108	465	473	491	Impact	RPS/4-IMP	89	159	465	473	497
Impact	RPS/1-IMP	63	108	500	508	526	Impact	RPS/4-IMP	89	159	530	538	562
Impact	RPS/1-IMP	63	108	530	538	556	Impact	RPS/4-IMP	89	159	600	608	632
Impact	RPS/1-IMP	63	108	600	608	626	Impact	RPS/4-IMP	89	159	670	678	702
Impact	RPS/1-IMP	63	108	700	708	726	Impact	RPS/4-IMP	89	159	700	708	732
Impact	RPS/1-IMP	63	108	750	758	776	Impact	RPS/4-IMP	89	159	750	758	782
Impact	RPS/1-IMP	63	108	800	808	826	Impact	RPS/4-IMP	89	159	800	808	832
Impact	RPS/1-IMP	63	108	950	958	976	Impact	RPS/4-IMP	89	159	900	908	932
Impact	RPS/1-IMP	63	108	1150	1158	1176	Impact	RPS/4-IMP	89	159	950	958	982
Impact	RPS/1-IMP	63	108	1400	1408	1426	Impact	RPS/4-IMP	89	159	1000	1008	1032
Impact	RPS/1-IMP	63	108	1600	1608	1626	Impact	RPS/4-IMP	89	159	1150	1158	1182
							Impact	RPS/4-IMP	89	159	1400	1408	1432
							Impact	RPS/4-IMP	89	159	1600	1608	1632
							Impact	RPS/4-IMP	89	159	1800	1808	1832
							Impact	RPS/4-IMP	89	159	2000	2008	2032
							Impact	RPS/4-IMP	89	159	2200	2208	2232



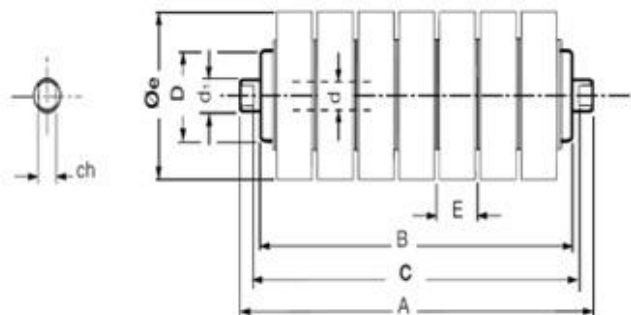

Code: **RollPlus**

**RPS/1-IMP,20F,89NA,323**

Type	Serie	Pipe Dia	Ring Dia	B	C	A
Impact	RPS/5-IMP	108	180	600	608	632
Impact	RPS/5-IMP	108	180	670	678	702
Impact	RPS/5-IMP	108	180	750	758	782
Impact	RPS/5-IMP	108	180	800	806	832
Impact	RPS/5-IMP	108	180	900	906	932
Impact	RPS/5-IMP	108	180	950	958	982
Impact	RPS/5-IMP	108	180	1000	1006	1032
Impact	RPS/5-IMP	108	180	1050	1058	1082
Impact	RPS/5-IMP	108	180	1100	1106	1132
Impact	RPS/5-IMP	108	180	1120	1128	1152
Impact	RPS/5-IMP	108	180	1250	1258	1282
Impact	RPS/5-IMP	108	180	1400	1406	1432
Impact	RPS/5-IMP	108	180	1500	1506	1532
Impact	RPS/5-IMP	108	180	1600	1606	1632
Impact	RPS/5-IMP	108	180	1800	1806	1832
Impact	RPS/5-IMP	108	180	2000	2006	2032
Impact	RPS/5-IMP	108	180	2200	2206	2232
Impact	RPS/5-IMP	108	180	2500	2506	2532
Impact	RPS/5-IMP	108	180	2800	2806	2832
Impact	RPS/5-IMP	108	180	3000	3006	3032
Impact	RPS/5-IMP	108	180	3150	3158	3182

Type	Serie	Pipe Dia	Ring Dia	B	C	A
Impact	RPS/5-IMP	133	194	600	608	632
Impact	RPS/5-IMP	133	194	670	678	702
Impact	RPS/5-IMP	133	194	750	758	782
Impact	RPS/5-IMP	133	194	800	806	832
Impact	RPS/5-IMP	133	194	900	906	932
Impact	RPS/5-IMP	133	194	950	958	982
Impact	RPS/5-IMP	133	194	1000	1006	1032
Impact	RPS/5-IMP	133	194	1050	1058	1082
Impact	RPS/5-IMP	133	194	1100	1106	1132
Impact	RPS/5-IMP	133	194	1120	1128	1152
Impact	RPS/5-IMP	133	194	1250	1258	1282
Impact	RPS/5-IMP	133	194	1400	1406	1432
Impact	RPS/5-IMP	133	194	1500	1506	1532
Impact	RPS/5-IMP	133	194	1600	1606	1632
Impact	RPS/5-IMP	133	194	1800	1806	1832
Impact	RPS/5-IMP	133	194	2000	2006	2032
Impact	RPS/5-IMP	133	194	2200	2206	2232
Impact	RPS/5-IMP	133	194	2500	2506	2532
Impact	RPS/5-IMP	133	194	2800	2806	2832
Impact	RPS/5-IMP	133	194	3000	3006	3032
Impact	RPS/5-IMP	133	194	3150	3158	3182



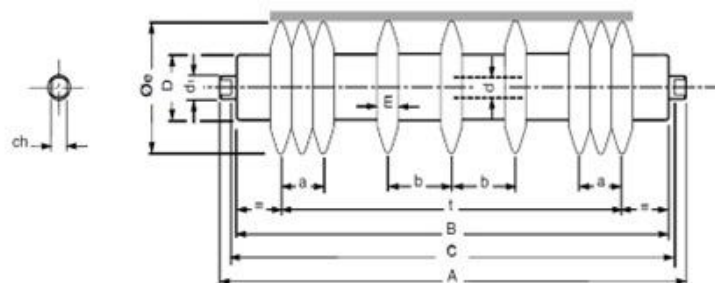

Code: **RollPlus**

RPS/1-RTR,20F,89NA,323

Type	Serie	Pipe Dia	Ring Dia	Design	B	C	A	Ring Qty.
Return	RPS/1-RTR	60	108	NG	380	388	406	5
Return	RPS/1-RTR	60	108	NG	500	508	526	5
Return	RPS/1-RTR	60	108	NG	600	608	626	6
Return	RPS/1-RTR	60	108	NG	750	758	776	9
Return	RPS/1-RTR	60	108	NG	950	958	976	10
Return	RPS/1-RTR	60	108	NG	1150	1158	1176	12
Return	RPS/1-RTR	60	108	NG	1400	1408	1426	13
Return	RPS/1-RTR	60	108	NG	1600	1608	1626	15
Return	RPS/1-RTR	60	133	NG	380	388	406	5
Return	RPS/1-RTR	60	133	NG	500	508	526	5
Return	RPS/1-RTR	60	133	NG	600	608	626	6
Return	RPS/1-RTR	60	133	NG	750	758	776	9
Return	RPS/1-RTR	60	133	NG	950	958	976	10
Return	RPS/1-RTR	60	133	NG	1150	1158	1176	12
Return	RPS/1-RTR	60	133	NG	1400	1408	1426	13
Return	RPS/1-RTR	60	133	NG	1600	1608	1626	15
Return	RPS/1-RTR	60	133	NG	1800	1808	1826	17

Type	Serie	Pipe Dia	Ring Dia	Design	B	C	A	Ring Qty.
Return	RPS/1-RTR	60	108	NL	380	388	406	5
Return	RPS/1-RTR	60	108	NL	500	508	526	6
Return	RPS/1-RTR	60	108	NL	600	608	626	7
Return	RPS/1-RTR	60	108	NL	750	758	776	8
Return	RPS/1-RTR	60	108	NL	950	958	976	10
Return	RPS/1-RTR	60	108	NL	1150	1158	1176	12
Return	RPS/1-RTR	60	108	NL	1400	1408	1426	13
Return	RPS/1-RTR	60	108	NL	1600	1608	1626	15
Return	RPS/2-RTR	89	133	NL	600	608	626	9
Return	RPS/2-RTR	89	133	NL	750	758	776	10
Return	RPS/2-RTR	89	133	NL	950	958	976	12
Return	RPS/2-RTR	89	133	NL	1150	1158	1176	14
Return	RPS/2-RTR	89	133	NL	1400	1408	1426	15
Return	RPS/2-RTR	89	133	NL	1600	1608	1626	16
Return	RPS/2-RTR	89	133	NL	1800	1808	1826	17
Return	RPS/2-RTR	89	133	NL	2000	2008	2032	18
Return	RPS/2-RTR	89	133	NL	2200	2208	2232	19





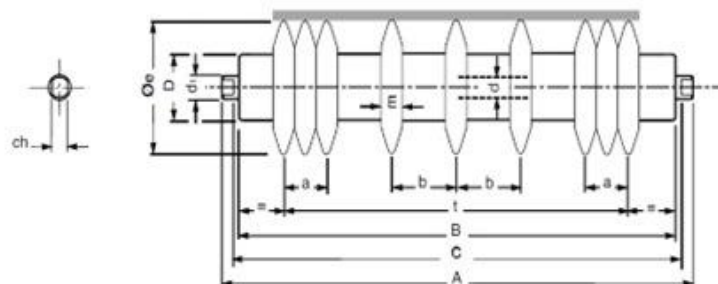

Code: **RollPlus**

RPS/1-RTR,20F,89NA,323

Type	Serie	Pipe Dia	Ring Dia	Design	B	C	A	Ring Qty.
Return	RPS/4-RTR	89	159	NL	600	608	626	7
Return	RPS/4-RTR	89	159	NL	750	758	776	8
Return	RPS/4-RTR	89	159	NL	950	958	976	10
Return	RPS/4-RTR	89	159	NL	1150	1158	1176	12
Return	RPS/4-RTR	89	159	NL	1400	1408	1426	13
Return	RPS/4-RTR	89	159	NL	1600	1608	1626	14
Return	RPS/4-RTR	89	159	NL	1800	1808	1826	15
Return	RPS/4-RTR	89	159	NL	2000	2008	2032	16
Return	RPS/4-RTR	89	159	NL	2200	2208	2232	17
Return	RPS/7-RTR	108	180	NL	950	958	976	12
Return	RPS/7-RTR	108	180	NL	1150	1158	1176	14
Return	RPS/7-RTR	108	180	NL	1400	1408	1426	15
Return	RPS/7-RTR	108	180	NL	1600	1608	1626	16
Return	RPS/7-RTR	108	180	NL	1800	1808	1826	17
Return	RPS/7-RTR	108	180	NL	2000	2008	2032	18
Return	RPS/7-RTR	108	180	NL	2200	2208	2232	19
Return	RPS/7-RTR	108	180	NL	2500	2508	2532	20

Type	Serie	Pipe Dia	Ring Dia	Design	B	C	A	Ring Qty.
Return	RPS/1-RTR	63	108	NC	200	208	226	3
Return	RPS/1-RTR	63	108	NC	250	258	276	3
Return	RPS/1-RTR	63	108	NC	315	323	341	4
Return	RPS/1-RTR	63	108	NC	380	388	406	4
Return	RPS/1-RTR	63	108	NC	465	473	491	5
Return	RPS/1-RTR	63	108	NC	600	608	626	6
Return	RPS/1-RTR	63	108	NC	700	708	726	7
Return	RPS/1-RTR	63	108	NC	800	808	826	8
Return	RPS/2-RTR	89	133	NC	315	323	341	5
Return	RPS/2-RTR	89	133	NC	380	388	406	5
Return	RPS/2-RTR	89	133	NC	465	473	491	6
Return	RPS/2-RTR	89	133	NC	600	608	626	7
Return	RPS/2-RTR	89	133	NC	700	708	726	8
Return	RPS/2-RTR	89	133	NC	800	808	826	8
Return	RPS/2-RTR	89	133	NC	900	908	926	9
Return	RPS/2-RTR	89	133	NC	1000	1008	1026	10
Return	RPS/2-RTR	89	133	NC	1100	1108	1126	11



## Darbe-Dönüş İkili Rulo Seti

*Impact-Return Double Roller Set*

---



**İNTRALOJİSTİK HATTI**  
*INTRALOGISTIC LINE*

# Anahtar Ağzı Tipleri

## Spindle Wrench Types

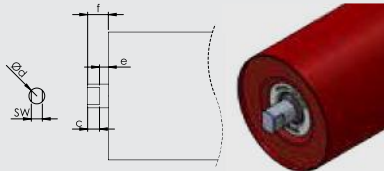

TİP-1	AÇIK ANAHTAR AĞZI / FLAT KEY TYPE			
d	20	25	30	40
SW	14	18	22	32
e	4	4	4	4
c	9	12	12	12
f	13	16	16	16

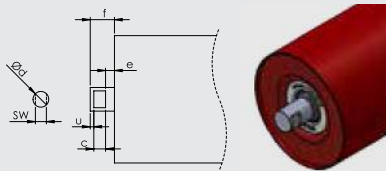

TİP-2	KAPALI ANAHTAR AĞZI / INTERNAL FLAT KEY TYPE				
d	15	20	25	30	40
SW	11	14	18	22	32
e	4	4	4	4	4
c	5	9	12	12	12
u	4	4	4	4	4
f	13	17	20	20	20

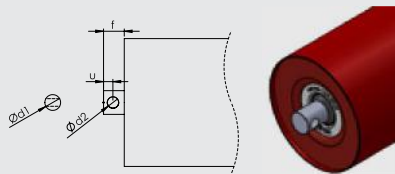

TİP-3	DELİK (GARLAND) ANAHTAR AĞZI / HOLE (GARLAND) KEY TYPE				
d1	15	20	25	30	40
u	7	10	12	16	16
f	17	24	28	36	38
d2	6	8	10	14	16

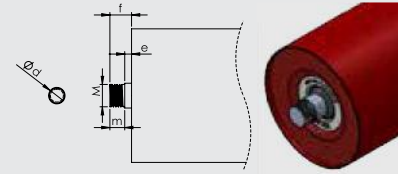

TİP-4	DIŞ DIŞ ANAHTAR AĞZI / OUTER THREADED KEY TYPE			
d	15	20	25	30
e	8	8	8	8
m	33	35	35	40
f	41	43	43	48
M	14	16	20	24

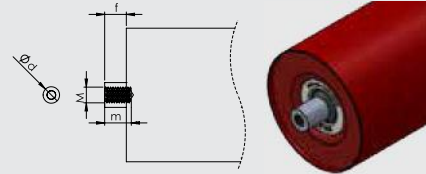

TİP-5	İÇ DIŞ ANAHTAR AĞZI / INNER THREADED KEY TYPE				
d	15	20	25	30	40
d1	20	20	25	30	40
f	8	13	16	16	16
m	18	20	25	25	25
M	10	12	16	16	16

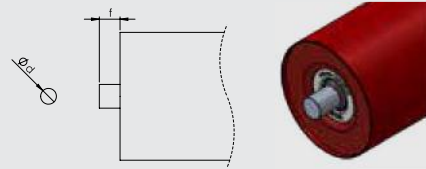

TİP-6	DÜZ MİL ANAHTAR AĞZI / PLAIN KEY TYPE				
d	15	20	25	30	40
f	13	13	13	16	16

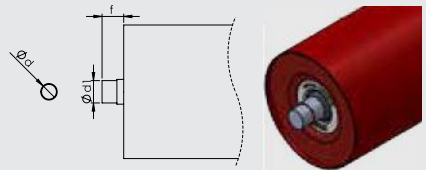

TİP-7	MİL İŞLEME / DIAMETER REDUCTION				
d	15	20	25	30	40
d1	it varies according to demand.				
f					



# Gergi Tamburu

## Tension Pulley

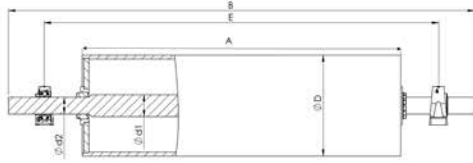

Aksi belirtilmedikçe tüm ölçüler mm cinsindedir./All dimensions are in mm unless otherwise stated.									
BELT	ØD	A	E	B	Ød1	Ød2	KG	YATAK / BEARING	PENS KİLİT / CLAMP LOCK
300	165	400	600	670	40	30	25,3	RTUE 30	CTL SERIES - 30
	190			680	40	30	30,6	RTUE 40	CTL SERIES - 40
	215				50	40	35,2		
	240				50	40	38,5		
	270				50	40	41,9		
400	270	500	700	690	50	50	48,4	RTUE 50	CTL SERIES - 50
	190			780	60	40	54,9	RTUE 40	CTL SERIES - 40
	215				50	40	41		
	240				50	40	44,8		
	270				50	40	48,7		
	320				50	40	56,3		
	400			790	60	40	63,5	RTUE 50	CTL SERIES - 50
				780	60	40	64,8		
				790	60	40	71,9		
				780	60	50	89,9		
					60	60	97	RTUE 60	CTL SERIES - 60
500	215	600	830	810	75	40	106,8	RTUE 40	CTL SERIES - 40
	240			910	50	40	51,3		
	270				50	40	55,6		
	320				50	40	64,4		
	400				40	50	72,3	RTUE 50	CTL SERIES - 50
	500			920	60	50	73,7	RTUE 40	CTL SERIES - 40
	630			910	50	40	81,6	RTUE 50	CTL SERIES - 50
				920	50	50	92,8	RTUE 60	CTL SERIES - 60
				940	75	60	102,5	RTUE 40	CTL SERIES - 40
				920	50	40	110,4	RTUE 50	CTL SERIES - 50
				940	60	50	121,5	RTUE 60	CTL SERIES - 60
				910	75	60	130,7	RTUE 40	CTL SERIES - 40
				920	60	50	138,6	RTUE 50	CTL SERIES - 50
				940	75	60	149,7	RTUE 60	CTL SERIES - 60
				910	85	70	166,4	RTUE 70	CTL SERIES - 70
				920	55	50	200,5	RTUE 50	CTL SERIES - 50
				940	75	60	211,7	RTUE 60	CTL SERIES - 60
					85	70	231,6	RTUE 70	CTL SERIES - 70
					95	80	243,7	RTUE 80	CTL SERIES - 80
650	240	750	990	1070	50	40	65,4	RTUE 40	CTL SERIES - 40
	270			1080	50	40	75,8		
	320				60	50	84,8	RTUE 50	CTL SERIES - 50
	400				50	40	86,4	RTUE 40	CTL SERIES - 40
	500				60	50	95,4	RTUE 50	CTL SERIES - 50
	630			1100	75	60	108,4	RTUE 60	CTL SERIES - 60
	800			1070	85	70	123,2	RTUE 70	CTL SERIES - 70
					50	40	120,5	RTUE 40	CTL SERIES - 40
					60	50	129,5	RTUE 50	CTL SERIES - 50
					75	60	142,4	RTUE 60	CTL SERIES - 60
					85	70	158,4	RTUE 70	CTL SERIES - 70
				1080	65	50	161,7	RTUE 50	CTL SERIES - 50
				1100	75	60	174,7	RTUE 60	CTL SERIES - 60
					85	70	192,8	RTUE 70	CTL SERIES - 70
					95	80	206,6	RTUE 80	CTL SERIES - 80
					75	60	247,5	RTUE 60	CTL SERIES - 60
					85	70	268,9	RTUE 70	CTL SERIES - 70
				1100	95	80	282,7	RTUE 80	CTL SERIES - 80
					105	90	297,8	RTUE 90	CTL SERIES - 90
					85	70	262,4	RTUE 70	CTL SERIES - 70
					95	80	375,9	RTUE 80	CTL SERIES - 80
					105	90	391	RTUE 90	CTL SERIES - 90
				1115	100	100	429,5	RTUE 100	CTL SERIES - 100

# Gergi Tamburu

## Tension Pulley

Aksi belirtilmedikçe tüm ölçüler mm cinsindedir./All dimensions are in mm unless otherwise stated.													
BELT	ØD	A	E	B	Ød1	Ød2	KG	YATAK / BEARING	PENS KİLİT / CLAMP LOCK				
800	270	950	1045	1285	60	50	101	RTUE 50	CTL SERIES - 50				
	320		1100	1340	70	60	128	RTUE 60	CTL SERIES - 60				
	400		1110	1350	80	70	187	RTUE 70	CTL SERIES - 70				
	500		1130	1370	90	80	243	RTUE 80	CTL SERIES - 80				
	630		1150	1390	100	90	351	RTUE 90	CTL SERIES - 90				
1000	240	1150	1390	1470	50	40	89,7	RTUE 40	CTL SERIES - 40				
	50				40	104,4							
	270			1480	60	50	116,1	RTUE 50	CTL SERIES - 50				
					60	50	129,8						
	320			1500	75	60	147,2	RTUE 60	CTL SERIES - 60				
					85	70	165,9	RTUE 70	CTL SERIES - 70				
					75	60	195,1	RTUE 60	CTL SERIES - 60				
					85	70	215	RTUE 70	CTL SERIES - 70				
					95	80	233,2	RTUE 80	CTL SERIES - 80				
					105	90	253,1	RTUE 90	CTL SERIES - 90				
					85	70	259,6	RTUE 70	CTL SERIES - 70				
					95	80	277,8	RTUE 80	CTL SERIES - 80				
	500			105	90	297,7	RTUE 90	CTL SERIES - 90					
				1510	115	100	328	RTUE 100	CTL SERIES - 100				
	630			1500	95	80	382,1	RTUE 80	CTL SERIES - 80				
					105	90	402	RTUE 90	CTL SERIES - 90				
					1510	115	100	437,2	RTUE 100	CTL SERIES - 100			
					1520	125	110	462,5	RTUE 110	CTL SERIES - 110			
					1500	95	80	504,5	RTUE 80	CTL SERIES - 80			
						105	90	524,4	RTUE 90	CTL SERIES - 90			
	800			1510	115	100	568,2	RTUE 100	CTL SERIES - 100				
					1520	125	110	593,4	RTUE 110	CTL SERIES - 110			
					1500	105	90	713,4	RTUE 90	CTL SERIES - 90			
					1510	115	100	769,7	RTUE 100	CTL SERIES - 100			
					1520	125	110	794,9	RTUE 110	CTL SERIES - 110			
					1520	135	120	822,9	RTUE 120	CTL SERIES - 120			
					1200	1400	1650	1730	50	40	121,2	RTUE 40	CTL SERIES - 40
								1740	60	50	134,6	RTUE 50	CTL SERIES - 50
	1730			50				40	136,6	RTUE 40	CTL SERIES - 40		
	1740			60				50	150	RTUE 50	CTL SERIES - 50		
1760	75	60	170,4	RTUE 60				CTL SERIESİ - 60					
	75	60	226,5										
	85	70	248,4	RTUE 70				CTL SERIES - 70					
	95	80	269,8	RTUE 80				CTL SERIES - 80					
95	80	320,4											
105	90	343,5	RTUE 90	CTL SERIES - 90									
500	1770	115	100	377,2				RTUE 100	CTL SERIES - 100				
	1780	125	110	456,2				RTUE 110	CTL SERIES - 110				
	1760	105	90	646,8	RTUE 90	CTL SERIES - 90							
	1770	115	100	503,4	RTUE 100	CTL SERIES - 100							
630	1780	125	110	532,5	RTUE 110	CTL SERIES - 110							
		135	120	564,5	RTUE 120	CTL SERIES - 120							
		1760	105	90	604,7	RTUE 90	CTL SERIES - 90						
		1770	115	100	651,9	RTUE 100	CTL SERIES - 100						
800	1780	125	110	680,9	RTUE 110	CTL SERIES - 110							
		135	120	712,9	RTUE 120	CTL SERIES - 120							
		1770	105	100	881,5	RTUE 100	CTL SERIES - 100						
		1780	125	110	910,5	RTUE 110	CTL SERIES - 110						
		135	120	942,6	RTUE 120	CTL SERIES - 120							
		1800	155	130	1008,7	RTUE 130	CTL SERIES - 130						

# Tahrik Tamburu

## Drive Pulley

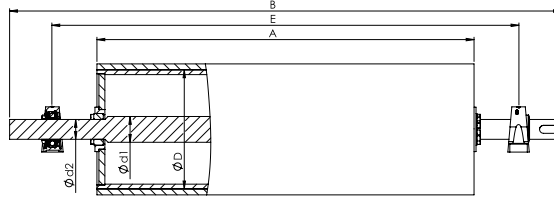

Aksi belirtilmedikçe tüm ölçüler mm cinsindedir./All dimensions are in mm unless otherwise stated.										
BELT	ØD	A	E	B	Ød1	Ød2	KAMA ÖLÇÜSÜ(bxt) / WEDGE SIZE	KG	YATAK / BEARING	PENS KİLİT / CLAMP LOCK
300	190	400	600	780	50	40	10x8	35,9	SN509	CTL SERIES - 40
	215			780	50	40	10x8	39,2	SN509	CTL SERIES - 40
	240			810	60	50	14x6	46,4	SN511	CTL SERIES - 50
	270			780	50	40	10x8	42,6	SN509	CTL SERIES - 40
	320			810	60	50	14x9	49,8	SN511	CTL SERIES - 50
				810	60	50	14x9	56,4	SN511	CTL SERIES - 50
				810	60	50	14x9	63,9	SN511	CTL SERIES - 50
				850	75	60	16x10	73,6	SN513	CTL SERIES - 60
400	215	500	700	880	50	40	10x8	45,5	SN509	CTL SERIES - 40
	240			910	60	50	14x9	53,5	SN511	CTL SERIES - 50
	270			880	50	40	10x8	49,4	SN509	CTL SERIES - 40
	320			910	60	50	14x9	57,2	SN511	CTL SERIES - 50
	400			910	60	50	14x9	64,9	SN511	CTL SERIES - 50
				910	60	50	14x9	73,3	SN511	CTL SERIES - 50
				950	75	60	16x10	84,2	SN513	CTL SERIES - 60
				950	75	60	16x10	109,4	SN513	CTL SERIES - 60
500	240	600	830	1040	60	50	14x9	65	SN511	CTL SERIES - 50
	270			1080	75	60	16x10	77,3	SN513	CTL SERIES - 60
	320			1040	60	50	14x9	73,8	SN511	CTL SERIES - 50
	400			1080	75	60	16x10	86,1	SN513	CTL SERIES - 60
	500			1040	60	50	14x9	83,1	SN511	CTL SERIES - 50
	630			1080	75	60	16x10	95,4	SN513	CTL SERIES - 60
				1110	85	70	18x11	110,4	SN516	CTL SERIES - 70
				1080	75	60	16x10	124,1	SN513	CTL SERIES - 60
				1110	85	70	18x11	140,3	SN516	CTL SERIES - 70
				1040	95	80	20x12	154,4	SN518	CTL SERIES - 80
				1080	75	60	16x104	152,3	SN513	CTL SERIES - 60
				1110	85	70	18x11	170,7	SN516	CTL SERIES - 70
				1140	95	80	20x12	184,8	SN518	CTL SERIES - 80
				1080	75	60	16x10	214,3	SN513	CTL SERIES - 60
				1110	85	70	18x11	235,9	SN516	CTL SERIES - 70
				1140	95	80	20x12	250	SN518	CTL SERIES - 80
				1175	105	90	22x14	266,5	SN520	CTL SERIES - 90
650	320	750	990	1170	50	40	10x8	87,2	SN509	CTL SERIES - 40
	400			1200	60	50	14x9	96,9	SN511	CTL SERIES - 50
	500			1240	75	60	16x10	111	SN513	CTL SERIES - 60
	630			1270	85	70	18x11	127,5	SN516	CTL SERIES - 70
	800			1170	50	40	10x8	121,3	SN509	CTL SERIES - 40
				1200	60	50	14x9	131	SN511	CTL SERIES - 50
				1240	75	60	16x10	145	SN513	CTL SERIES - 60
				1270	85	70	18x11	162,7	SN516	CTL SERIES - 70
				1200	60	50	14x9	163,2	SN511	CTL SERIES - 50
				1240	75	60	16x10	177,3	SN513	CTL SERIES - 60
				1270	85	70	18x10	197,1	SN516	CTL SERIES - 70
				1300	95	80	20x12	212,9	SN518	CTL SERIES - 80
				1240	75	60	22x14	250,1	SN513	CTL SERIES - 60
				1270	85	70	18x11	273,2	SN516	CTL SERIES - 70
				1300	95	80	20x12	289	SN518	CTL SERIES - 80
				1335	105	90	22x14	307,5	SN520	CTL SERIES - 90
				1270	85	70	18x11	366,4	SN516	CTL SERIES - 70
				1300	95	80	20x12	382,2	SN518	CTL SERIES - 80
				1335	105	90	22x14	400,7	SN520	CTL SERIES - 90
				1350	115	100	25x14	441,9	SN522	CTL SERIES - 100

# Tahrik Tamburu

## Drive Pulley

Aksi belirtilmedikçe tüm ölçüler mm cinsindedir./All dimensions are in mm unless otherwise stated.											
BELT	ØD	A	E	B	Ød1	Ød2	KAMA ÖLÇÜSÜ(bxt) / WEDGE SIZE	KG	YATAK / BEARING	PENS KİLİT / CLAMP LOCK	
800	400	950	1190	1400	60	50	14x9	155,4	SN511	CTL SERIES - 50	
				1440	75	60	16x10	171,7	SN513	CTL SERIES - 60	
				1470	85	70	18x11	191	SN516	CTL SERIES - 70	
				1500	95	80	20x12	209,3	SN518	CTL SERIES - 80	
	500			1400	60	50	14x9	193	SN511	CTL SERIES - 50	
				1440	75	60	16x10	209,3	SN513	CTL SERIES - 60	
				1470	85	70	18x11	231,1	SN516	CTL SERIES - 70	
				1500	95	80	20x12	249,1	SN518	CTL SERIES - 80	
	630			1470	85	70	18x11	321,4	SN516	CTL SERIES - 70	
				1500	95	80	20x12	339,4	SN518	CTL SERIES - 80	
				1535	105	90	22x14	360,2	SN520	CTL SERIES - 90	
				1550	115	100	25x14	395,5	SN522	CTL SERIES - 100	
	800			1500	95	80	20x12	447,4	SN518	CTL SERIES - 80	
				1535	105	90	22x14	468,2	SN520	CTL SERIES - 90	
				1550	115	100	25x14	512,1	SN522	CTL SERIES - 100	
				1580	125	110	28x16	538,5	SN524	CTL SERIES - 110	
	1000			1535	105	90	22x14	634,1	SN520	CTL SERIES - 90	
				1550	115	100	25x14	690,5	SN522	CTL SERIES - 100	
				1580	125	110	28x16	716,9	SN524	CTL SERIES - 110	
				1610	145	125	28x16	767,6	SN528	CTL SERIES - 125	
1000	400	1150	1390	1600	85	70	18x11	219,3	SN516	CTL SERIES - 70	
				1600	95	80	20x12	239,4	SN518	CTL SERIES - 80	
				1600	95	80	20x12	284	SN518	CTL SERIES - 80	
				1600	105	90	22x14	307,3	SN520	CTL SERIES - 90	
	500			1600	115	100	25x14	340,4	SN522	CTL SERIES - 100	
				1600	125	110	28x16	369,7	SN524	CTL SERIES - 110	
				1650	105	90	22x14	411,6	SN520	CTL SERIES - 90	
				1650	115	100	25x14	449,6	SN522	CTL SERIES - 100	
	630			1650	125	110	28x16	479	SN524	CTL SERIES - 110	
				1650	145	125	28x16	536,1	SN528	CTL SERIES - 125	
				1650	105	90	22x14	534	SN520	CTL SERIES - 90	
				1650	115	100	25x14	580,6	SN522	CTL SERIES - 100	
	800			1650	125	110	28x16	609,9	SN524	CTL SERIES - 110	
				1650	145	125	28x16	667,1	SN528	CTL SERIES - 125	
				1725	115	100	25x14	782,1	SN522	CTL SERIES - 100	
				1725	125	110	28x16	811,4	SN524	CTL SERIES - 110	
	1000			1725	145	125	28x16	868,6	SN528	CTL SERIES - 125	
				1725	155	135	32x18	910,3	SN530	CTL SERIES - 135	
				1725	125	110	28x16	1064,8	SN522	CTL SERIES - 110	
				1725	145	125	28x16	1122,1	SN524	CTL SERIES - 125	
1250	1725	155	135	32x18	1163,6	SN528	CTL SERIES - 135				
	1725	165	140	32x18	1320	SN530	CTL SERIES - 140				
	1200	500	1400	1650	1910	95	80	20x12	326,7	SN518	CTL SERIES - 80
					1910	105	90	22x14	353,1	SN520	CTL SERIES - 90
1910					115	100	25x14	515,8	SN522	CTL SERIES - 100	
1910					125	110	28x16	549	SN524	CTL SERIES - 110	
630		1910			145	125	28x16	614,5	SN528	CTL SERIES - 125	
		1910			135	135	32x18	660,9	SN530	CTL SERIES - 135	
		1910			115	100	36x25	664,3	SN522	CTL SERIES - 100	
		1910			125	110	28x16	697,4	SN524	CTL SERIES - 110	
800		1910			145	125	28x16	763	SN528	CTL SERIES - 125	
		1910			155	135	32x18	809,3	SN530	CTL SERIES - 135	
		1985			125	110	28x16	927	SN524	CTL SERIES - 110	
		1985			145	125	28x16	992	SN528	CTL SERIES - 125	
1000	1985	155			135	32x18	1039	SN530	CTL SERIES - 135		
	1985	165			140	32x18	1132	SN532	CTL SERIES - 140		
	1985	145			125	28x16	1277,1	SN528	CTL SERIES - 125		
	1985	155			135	32x18	1323,3	SN530	CTL SERIES - 135		
1250	1985	165			140	32x18	1446,9	SN532	CTL SERIES - 140		
	1985	185			160	36x20	1541	SN532	CTL SERIES - 160		



# Konveyör Rulo İstasyonu

## Conveyor Roller Station

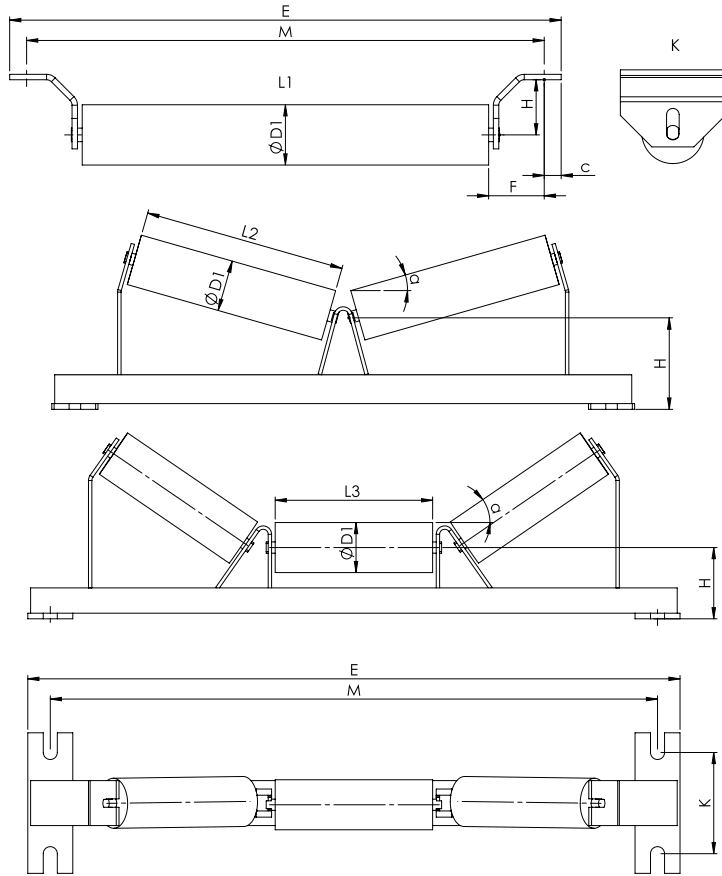

$\alpha^\circ$
10° / 20° / 30° / 35° / 45°
İstasyon bağlantı ölçü değeri M, konveyör bant şase ölçüsüne göre değişiklik göstermektedir. Station connection size value M varies according to the conveyor belt chassis size.

Aksi belirtilmedikçe tüm ölçüler mm cinsindedir./All dimensions are in mm unless otherwise stated.								
BELT	ØD1	E	H	L1	L2	L3	F	K
400	89	700	62	500	250	160	70	90-180
	108		75				70	
	108		85				65	
500	60	800	62	600	315	200	65	
	89		75				65	
	108		85				65	
650	60	950	62	750	380	250	55	
	89		75					
	108		85					
800	89	1150	62	950	465	315		
	108		75					
	133		85					
1000	89	1350	75	1150	600	380		
	108		85					
	133		100					
1200	159	1600	130	1400	700	465		
	89		85					
	133		100					
1400	159	1800	130	1600	800	530		
	133		100					
	159		130					
1600	133	2050	100	1800	900	600	90	
	159		130				85	
							50	
1800	133	2250	100	2000	1000	670	115	
	159		130				110	
	133		100				105	
2000	159	2500	130	2200	1100	750		
	194		160					
	159		130					
2200	194	2700	160	2500	1250	800		
	159		130					
	194		160					
2400	159	2950	130	2800	1400	900		
	194		160					
	159		130					
2600	194	3150	160	3000	1500	950		
	159		130					
	194		160					
2800	159	3400	130	3150	1600	1050		
	194		160					
	219		180					
3000	159	3600	130	3350	1700	1120		
	194		160					
	219		180					

**HAVALİMANI**  
*AIRPORT*



**ÇİMENTO FABRİKASI**  
*CEMENT FACTORY*



**MADEN TESİSİ**  
*MINING PLANT*



**AHŞAP İŞLEME FABRİKASI**  
*WOOD PROCESSING FACTORY*

**2023  
Türkiye Madencilik  
Kongresi ve Fuarı**



**Mayıs 2024  
İstanbul 11. Uluslararası  
Madencilik Fuarı**

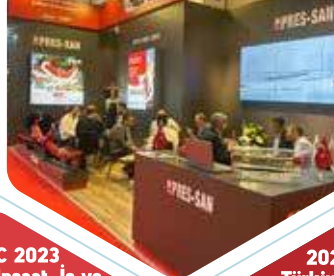

**Fas Ticaret Heyeti  
Maroc Commercial Meeting  
30.09.2024-03.10.2024**



**2022 İstanbul  
10. Uluslararası  
Madencilik Fuarı**



**SMOPYC 2023  
Uluslararası İnşaat, İş ve  
Maden Makineleri Fuarı**



**2023 Ankara  
Türkiye Madencilik  
Kongresi ve Fuarı**



**Fuarlar  
Fairs**

**23. Batımatec  
2021 Cezayir  
Fuarı**



**2024  
18. Uluslararası Cevher  
Hazırlama Sempozyumu**



**Bauma/Almanya  
07-13.04.2025**



**2021  
9. Uluslararası  
Madencilik Fuarı**



**2019  
İzmir  
8. Minex Fuarı**

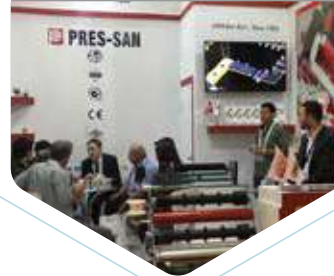



**TÜPRAG UŞAK**  
*TÜPRAG UŞAK*

**YATAK ÜRETİM HATTI**  
*MATTRESS PRODUCTION LINE*



**TAŞ KIRMA ELEME TESİSİ**  
*STONE CRUSHING SCREENING PLANT*



**ŞİŞELEME-PAKETLEME HATTI**  
*BOTTLE FILLING LINE*



# TSE ONAYLI RULO DENEY LABORATUVARI

## *TSE CERTIFIED ROLLER TEST LABORATORY*

**Su Testi**  
*Water Proof Test*



**Salgı Testi**  
*Secretion Test*



**Sürtünme Testi**  
*Friction Test*



**Toz Testi**  
*Dust Proof Test*



**Eksenel Kayma Ve Baskı Dayanım**  
*Axial Deflection and Compressive Strength*



”

**+41 yıllık tecrübe ve  
konusunda uzman kadro**  
More than 41 years of  
*experience and  
expert staff*



# Referanslar

## References







**EN 1090 A1:2011 EXC2**



rollplus.net

 Ankara 1. OSB Ural Caddesi No: 7 Sincan – Ankara / TÜRKİYE

 +90 312 267 42 42 (Pbx)

 +90 312 267 40 70

 sales@pres-san.com

 [www.rollplus.net](http://www.rollplus.net)